

**Fisher Engineering**

P.O. Box 529 Rockland, Maine 04841

August 15, 2003  
Lit. No. 64025**Minute  
Mount**  
SYSTEM**Minute<sup>2</sup>**  
SYSTEM

## Attachment Kit Installation Instructions

GMC Sierra	K1500	2003–20__
Chevy Silverado	K1500	2003–20__

**⚠ CAUTION**

Read this document before installing the snowplow.

**⚠ CAUTION**

See your FISHER® outlet for application recommendations. The Kit Selection Guide has specific vehicle and snowplow requirements.

## SAFETY DEFINITIONS

### WARNING

Indicates a potentially hazardous situation that, if not avoided, could result in death or serious personal injury.

### CAUTION

Indicates a situation that, if not avoided, could result in damage to product or property.

**NOTE:** Identifies tips, helpful hints, and maintenance information the owner/operator should know.

## SAFETY PRECAUTIONS

Improper installation and operation could cause personal injury, and/or equipment and property damage. Read and understand labels and the *Owner's Manual* before installing, operating, or making adjustments.

### WARNING

Lower blade when vehicle is parked. Temperature changes could change hydraulic pressure, causing the blade to drop unexpectedly or damaging hydraulic components. Failure to do this can result in serious personal injury.

### WARNING

Remove blade assembly before placing vehicle on hoist.

### WARNING

The driver shall keep bystanders clear of the blade when it is being raised, lowered or angled. Do not stand between the vehicle and the blade or within 8 feet of a moving blade. A moving or falling blade could cause personal injury.

### WARNING

Keep hands and feet clear of the blade and A-frame when mounting or removing the snowplow. Moving or falling assemblies could cause personal injury.

### WARNING

Do not exceed GVWR or GAWR including blade and ballast. The rating label is found on driver-side vehicle door cornerpost.

### CAUTION

Refer to the Kit Selection Guide for minimum vehicle recommendations and ballast requirements.

### CAUTION

To prevent accidental movement of the blade, always turn the ON/OFF switch to OFF whenever the snowplow is not in use. The control indicator light will turn off.

## PERSONAL SAFETY

- Wear only snug-fitting clothing while working on your vehicle or snowplow.
- Do not wear jewelry or a necktie, and secure long hair.
- Wear safety goggles to protect your eyes from battery acid, gasoline, dirt and dust.
- Avoid touching hot surfaces such as the engine, radiator, hoses and exhaust pipes.
- Always have a fire extinguisher rated BC handy, for flammable liquids and electrical fires.

## FIRE AND EXPLOSION

### WARNING

Gasoline is highly flammable and gasoline vapor is explosive. Never smoke while working on a vehicle. Keep all open flames away from gasoline tanks and lines. Wipe up any spilled gasoline immediately.

Be careful when using gasoline. Do not use gasoline to clean parts. Store only in approved containers away from sources of heat or flame.

## VENTILATION

### WARNING



Vehicle exhaust contains deadly carbon monoxide (CO) gas. Breathing this gas, even in low concentrations, could cause death. Never operate a vehicle in an enclosed area without venting exhaust to the outside.

## TORQUE CHART

### CAUTION

Read instructions before assembling. Fasteners should be finger tight until instructed to tighten according to the torque chart. Use standard methods and practices when attaching snowplow including wearing proper personal protective safety equipment.

**Recommended Fastener Torque Chart (Ft.-Lb.)**

Size	 SAE Grade 2	 SAE Grade 5	 SAE Grade 8
1/4-20	6	9	13
5/16-18	11	18	28
3/8-16	19	31	46
3/8-24	24	46	68
7/16-14	30	50	75
1/2-13	45	75	115
9/16-12	66	110	165
5/8-11	93	150	225
3/4-10	150	250	370
7/8-9	150	378	591
1-8	220	583	893
<b>Metric Grade 8.8 (Ft.-Lb.)</b>			
Size	Torque	Size	Torque
M 6	7	M 12	60
M 8	17	M 14	95
M 10	35	M 16	155
These torque values apply to fasteners except those noted in the instruction.			

## INSTALLATION INSTRUCTIONS

1. **On Chevrolet Vehicles:** Remove the lower plastic section of the bumper. Save all plastic fasteners for use on reinstallation. Remove the tow hooks.

**On GMC Vehicles:** Remove the bumper. Save all fasteners for use on reinstallation. Remove the tow hooks.

2. Beginning with either pushplate, align the forward pushplate holes with the three tow hook holes in the frame. Insert a 1/2" x 1-1/4" cap screw through each side of the mount and into the frame. Place a 1/2" washer and 1/2" locknut on each cap screw and hand tighten.

**NOTE:** The cap screw heads must be on the outside of the frame to avoid interference with the bumper.

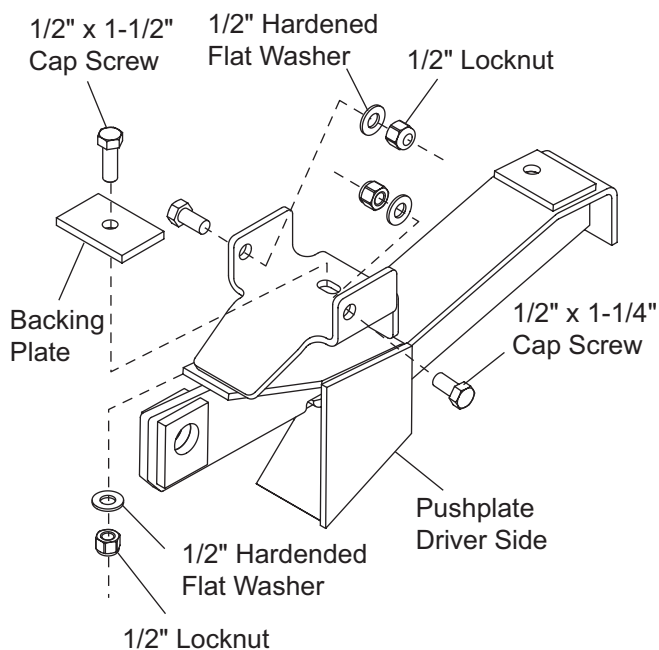

3. Insert a 1/2" x 1-1/2" cap screw down through a backing plate then through bottom of frame and the slot in the pushplate. The backing plate should span the inside bottom surface of the frame widthwise. Place a washer and locknut on the cap screw and hand tighten. Verify that the rear portion of the pushplate is in contact with the bottom portion of the frame.

4. Repeat steps 1 through 3 for the opposite side pushplate.
5. Check for a connecting arm distance of  $29\text{-}1/8" \pm 1/8"$ . If connecting arm distance is acceptable, tighten fasteners in the order indicated below. If connecting arm distance is not within  $29\text{-}1/8" \pm 1/8"$ , 1/2" flat washers may be used to shim one or both plates in the appropriate direction to obtain the desired dimension. Tighten fasteners in the order indicated below after achieving appropriate dimensions.

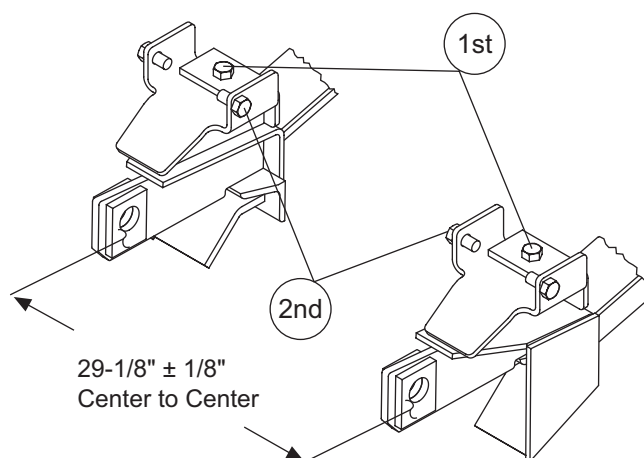

**⚠ CAUTION**

**When drilling holes for the passenger side pushplate, use care not to damage the aluminum hoses near the frame.**

6. Beginning with either pushplate, hold the rear of the pushplate tight against the vehicle frame and the cross member. Mark the two hole locations with a sharp object (scribe or nail). Remove the pushplate and center punch holes in the two places marked. Drill a 1/2" diameter hole in each marked location, one through the vehicle frame and one through the cross member. **(See photo below.)**

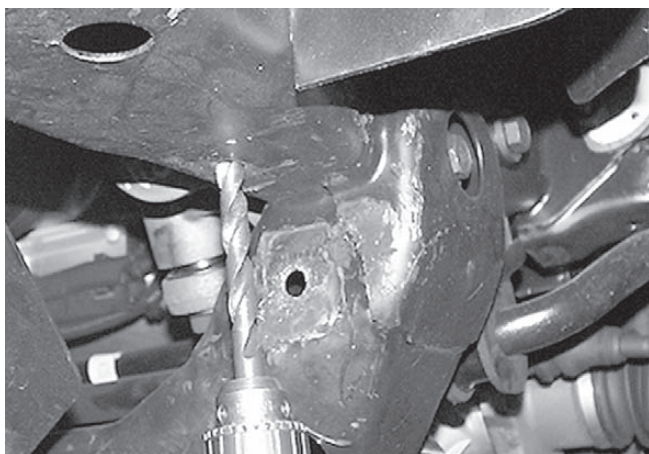

**NOTE:** Drill clearance can be obtained by turning the steering wheel so the front of the tire is away from side being drilled.

7. Attach the rear of the pushplate to the vehicle frame using a 1/2" bolt bar and 1/2" locknut. Attach the rear of the pushplate to the cross member using a 1/2" x 1-3/4" cap screw, 1/2" flat washer, and 1/2" locknut. **(See illustration below.)**
8. Reattach the front of pushplate as described in steps 1 through 5.
9. Repeat steps 6 through 8 for the opposite side pushplate.
10. Tighten all fasteners according to the Torque Chart on page 3.
11. Reattach lower plastic bumper or bumper and trim as necessary.

**NOTE:** After five to ten hours of snowplow usage, retorque all pushplate assembly fasteners.

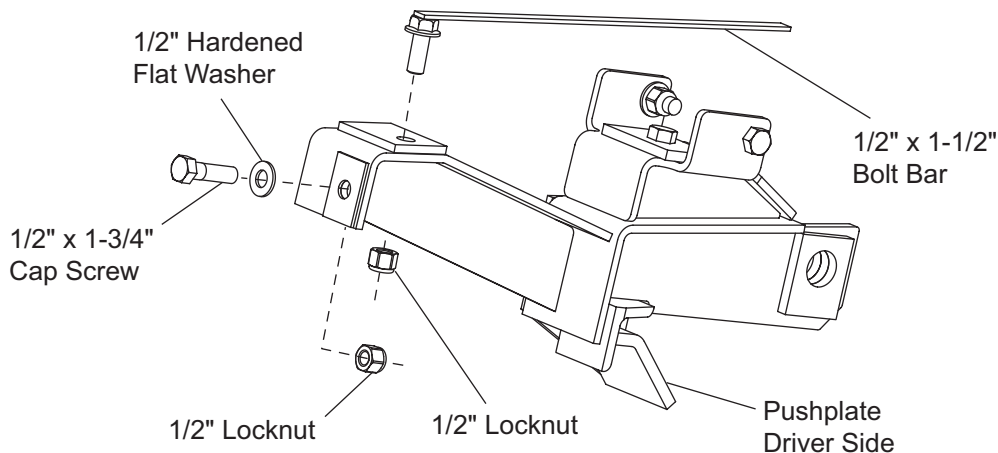

Fisher Engineering reserves the right under its product improvement policy to change construction or design details and furnish equipment when so altered without reference to illustrations or specifications used. Fisher Engineering and the vehicle manufacturer may require and/or recommend optional equipment for snow removal. Do not exceed vehicle ratings with a snowplow. Fisher Engineering offers a limited warranty for all snowplows and accessories. See separately printed page for this important information. The following are registered (®) trademarks of Douglas Dynamics, L.L.C.: FISHER®, Minute Mount®, Minute Mount®2.

---

Printed in U.S.A.