



PARTS & INSTALLATION INSTRUCTIONS

E-60 & E-60H QUIK LIFT®

PARTS LIST

ITEM	STANDARD- UP THROUGH	LONG STROKE- MDII	QTY.	DESCRIPTION	ITEM	STANDARD- UP THROUGH	LONG STROKE- MDII	QTY.	DESCRIPTION
	C-9 1-1/8" x 6" Stroke E-60	HM-9 & HM-10 1-1/8" x 8" Stroke E-60H				C-9 1-1/8" x 6" Stroke E-60	HM-9 & HM-10 1-1/8" x 8" Stroke E-60H		
1	15726	15726	1	Base & Tank Assembly	53a	15972	15972	1	"A" Solenoid Assembly
2	15706		1	• Sump Base	54a	15905	15905	1	•• "A" Coil, Black Wire
2	15335	15336	1	• Ram Assy. SEE ILLUSTRATION	55a	15660	15660	1	•• "A" Cartridge Valve
3	15208	15206	1	• Ram Assembly 1-3/4"	56	22435	22435	1	•• "A" Coil Nut
4	15158	15158	1	•• Ram	*	15431	15431	1	•• Seal Kit, "A" Valve
5	15219	15219	1	•• Piston	57	15758	15758	1	• VALVE ASSY w/COUJ
6*	15162	15162	1	•• Piston Follower	58	22295	22295	1	•• Forged 90 Degree Elbow
7*	15125	15125	1	•• Packing Cup	59	22293	22293	1	•• Coupler, Male Half Low Spill
8		15760	1	•• O-ring 7/16" I.D.	60	22294	22294	1	•• Coupler, Female Half Low Spill
9	20316	20316	1	•• Spacer	61	15606	15606	1	• Kit-Crossover Valve
10	15738	15738	1	•• Locknut 1/2-13	62			1	•• O-ring
11*	05119	05119	1	• Cover & Seal Assembly	63			1	•• O-ring
12*	15131	15131	1	•• Wiper	64			1	•• Cage
13	15737	15737	1	•• O-ring 3-1/2" I.D.	65			1	•• O-ring w/Glyd. Ring
14	08473	08473	1	•• Sleeve	66			1	•• Poppet
15	21805	21805	1	• Pressure Relief Valve Kit	67			1	•• Washer
16	21806	21806	1	•• Reducer Bushing 1/4-1/8	68			1	•• Guide
17	15696	15704	1	•• Pressure Relief Valve	69			1	•• Spring
18	15953	15205	1	• Cylinder Tank	70			1	•• Spacer
19*	15209	15209	1	• Cylinder	71			1	•• Disc
20*	15198	15198	1	• Washer	72			1	•• Plug
21a*	15131	15131	1	• O-ring 1-1/8 I.D.	73			1	•• Adj. Screw
21b*	15693	15183	1	• O-ring 3-1/2 I.D.	74			1	•• O-ring
22	20697	20697	3	• O-ring 1-1/2 I.D.	75			1	•• Acorn Nut 9/16-18
23	15708	15709	3	• O-ring 1-15/16 I.D.	*	15610	15610	1	•• Seal Kit-Crossover Valve
24*	21929	21929	5	• Locknut 5/16-24	76	15639	15639	1	(includes items 62,63,65,74)
25	22129	22129	1	• Stud	77			1	• Kit-Pilot Check Valve
26	15641	15641	2	• Washer, Nylite 5/16	78			1	•• Ball, Steel
27	15619	15619	1	• Plug w/O-ring 9/16"	79			1	•• Spring
28	21999	21999	1	• Filter Kit 9/16"	80	15609	15609	1	•• Plug
29	15695	15695	1	•• Filter	81	15359	15359	1	• Piston
30	15729	15729	1	•• Plug w/O-ring 9/16"	82*	15126	15126	1	• Plug Valve Block
31	15688	15688	2	• Spacer Ring	83	15697	15697	1	•• O-ring 9/16 I.D.
32	15713	15713	1	• Pump	84	15382	15382	1	• "B" Solenoid Assembly
33	15574	15574	1	• Dowel Pins	85	15698	15698	1	•• "B" Coil, Red Wire
34*	15124	15124	1	• Locator	*	15432	15432	1	•• "B" Cartridge Valve
35	15354	15354	1	• Pump Check Valve	86	15358	15358	1	•• Seal Kit-"B" Cartridge
36	15603	15603	1	•• O-ring 3/8 I.D.	87	15430	15430	1	• "C" Solenoid Assembly
37	15804	15804	1	•• Seat	88	15381	15381	1	•• "C" Coil, Green Wire
38*	15700	15700	1	•• Ball 9/32	*	15433	15433	1	•• "C"-Cartridge Valve
39	15702	15702	1	•• Spring	89	15576	15576	1	•• Seal Kit-"C" Cartridge
40	15699	15699	1	• O-ring 3/8 I.D.	90			1	• Kit-"B" Solenoid Check Valve
41*	15701	15701	1	• Ball Seat	91			1	•• Ball, 7/16
42	22118	22118	1	• Relief Valve	92	21826	21826	4	•• Spring
43	15703	15703	1	• O-ring "Special"					• Scr., Soc. Head 5/16-18 x 1-1/2"
44	22119	22119	2	• Socket Set Screw					
45	21083	21083	2	• Pump Mounting Plate					
46*	15122	15122	2	• Bolt 3/8-16 x 3-1/4" Gr. 5					
47a*	15123	15123	1	• Star Washer 3/8					
47b*	15124	15124	1	• O-ring 1/4 I.D.					
48	15841	15841	1	• O-ring 5/16 I.D.					
49a	15730	15730	1	• O-ring 3/8 I.D.					
49b	15892	15892	1	• Motor - Two Terminal					
50	22120	22120	2	• Cover/Motor Mount - Obsolete					
51	15686	15686	1	• Cover/Motor Mount w/tabs					
52*	15687	15687	1	• Cap Screw 5/16 x 3-1/4"					
53	15661	15661	1	• Pump Shaft Seal					
54	15659	15659	1	• O-ring 4-3/4 I.D.					
55	15660	15660	1	• "A" Solenoid Assembly					
*	15431	15431	1	•• "A" Coil, Black Wire					
				•• "A" Cartridge Valve					
				• Seal Kit, "A" Valve					

NOTES:

Parts indented are included in assembly under which they are indented.

1. * Parts included in Master Seal Kit Part No. 15705.
2. Basic Seal Kit Part No. 15707.
3. Set Crossover Relief Valve @ 3800 ± 400 P.S.I. @ 2-1/2 G.P.M.

E-60 with (1-1/4" Lift Ram Assembly)

Set Pump Relief Valve @ 2500 ± 50 P.S.I. full flow @ 1.85 G.P.M.

E-60 & E-60H with (1-3/4" Lift Ram Assembly)

Set Pump Relief Valve @ 2000 ± 50 P.S.I. full flow @ 1.85 G.P.M.

Meyer Products reserves the right, under its continuing product improvement program, to change construction or design details, specifications and prices without notice or without incurring any obligation.



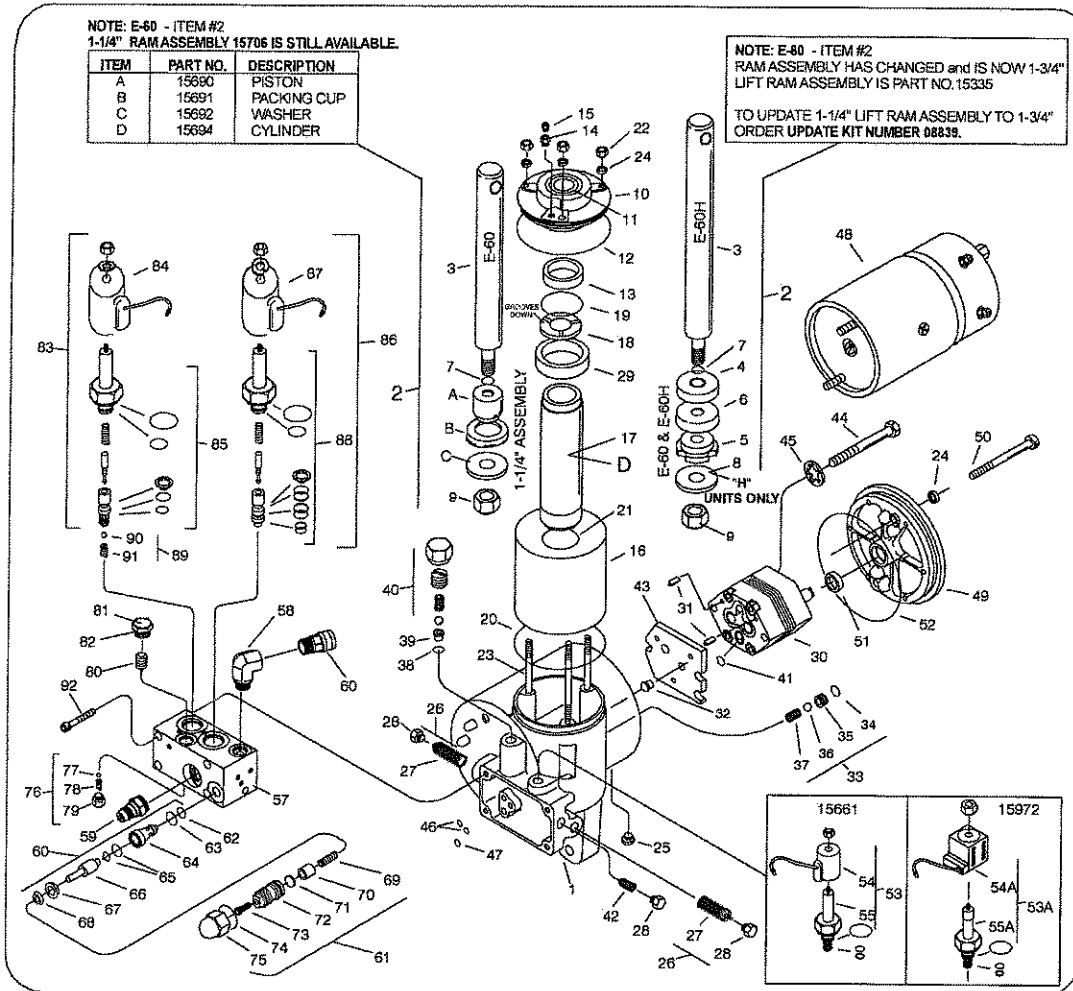

Note changes to items (47a - 47b) and (49a - 49b) identify part before ordering a replacement.

Note: Oil seepage, if any, at o-ring (M) is normal, Do Not attempt to stop this seepage by further tightening of the acorn nut.

Torque Specifications

	Thread Size	Torque (In. Lbs.)
Reservoir Cover		
Retaining Nuts	5/16-24	100-125
Pump Assembly		
Retaining Cap Screws	3/8-16	185 ± 5
End Plate or Valve Block		
Retaining Cap Screws	5/16-18	96-120
Motor to Pump Retaining		
Cap Screws	1/4-20	45-55
Motor Mounting Plate	5/16-18	100-125
Drain and Filter Plugs	9/16-18	75-85
"A" Coil Retainer Nut		40 ± 2

Hydraulic Specifications

PUMP - Pressure Output	
E-60 (1-1/4" Lift Ram)	2500 ± 50 P.S.I.
E-60 & E-60H (1-3/4" Lift Ram)	2000 ± 50 P.S.I.
Cross-Over Relief Valve Setting	3800 ± 400 P.S.I.

Hydraulic Fluid Capacity

Note: 1 Quart = 32 Fluid Ounces

Model E-60	
Unit	44 oz.
Hoses & 1-1/2" x 10" Cylinders	16 oz.
TOTAL	60 oz
Model E-60	
Unit	44 oz.
Hoses & 1-1/2" x 12" Cylinders	19 oz.
TOTAL	63 oz.
Model E-60H MDII	
Unit	48 oz.
Hoses & 1-1/2" x 10" Cylinders	16 oz.
TOTAL	64 oz
Model E-60H	
Unit	48 oz.
Hoses & 1-1/2" x 10" Cylinders	28 oz.
TOTAL	76 oz

GENERAL INFORMATION

Before the Meyer Quik-Lift® unit is disassembled for repairs, make certain that all the maintenance procedures have been checked. Refer to Owner's Manual.

When the unit is to be overhauled, Master Seal Kit Part No. 15705 is required. This Kit contains all necessary Seals for rebuilding. **NOTE: DO NOT REUSE OLD O-RINGS.**

When ordering parts, furnish Type of Unit, Part No., Name and Description.

These instructions are intended as a guideline for overhaul of an E-60 Quik-Lift® unit. More detailed information covering principles of Operation, Troubleshooting, Disassembly and Repair are found in Service Manual 1-667. This is available for a nominal fee from your Meyer Distributor.

DISASSEMBLY AND INSPECTION OF UNIT

Drain fluid from unit by removing Pressure Relief Valve (15) or Drain Plug (25). Clamp Sump Base (1) firmly into vise.

1. To disassemble Cover Assembly (10), Cylinder Tank (16), Lift Cylinder (17), and Ram Assembly (2), remove the three Locknuts (22) and Nyltite Washers (24).
2. To disassemble Motor (48), remove motor end cover screws, if needed, exposing motor mounting bolts. Loosen motor mounting bolts; **DO NOT EXTRACT FROM MOTOR.**
Note: Motor end plate to be held in place. Temporarily install two 1/4-20 nuts on the motor mounting bolts to keep motor intact. Remove nuts when reinstalling motor. Remove motor.
3. To disassemble Motor Mounting Cover (49), remove Bolts (50) and Nyltite Washers (24).
4. To disassemble Pump (30) from Sump Base (1), remove Bolts (44) and Starwashers (45).
5. To disassemble Pump Mounting Plate (43), remove Plate and Locator (32).
6. Remove Pump Check Valve (33).
7. To disassemble Valve Block from Sump Base (1), remove Soc. Hd. Screws (92).

SUB ASSEMBLIES - INSPECTION

1. COVER ASSEMBLY, TANK, RAM & CYLINDER PARTS:

- a) Check Cover Assembly (10), Sump Base (1), and Motor Mounting Cover (49) castings for cracks and damage.
- b) Replace Wiper Seal (11) pressed in Cover (10).
- c) Replace the Pump Shaft Seal (51) pressed in Motor Mounting Cover (49).
- d) Inspect Nylon Sleeve (13), Piston (4), the Piston Follower (5) on E-60H units for excessive wear. Replace Packing Cup (6). Inspect Cylinder (17) for scoring and pitting in bore.
- e) Inspect Ram (3) for nicks and rust.

2. MOTOR (48)

Note: Complete Motor Assemblies are only available from Meyer Products.

3. PUMP (30) - DO NOT at any time disassemble this Pump. This will void the warranty.

- a) The damaged pump shaft seal located in the Motor Mounting Cover (49) may be removed by careful extraction with a screwdriver.

CAUTION: Do not score seal bore in mounting cover. Dip new seal in oil with spring facing upward; press into Motor Mounting Cover (49).

4. BASE (1)

- a) Remove and clean "A" Solenoid (53) and inspect for external damage.
- b) Test Coil (54) for electrical continuity. Nominal coil resistance is 9.6 ohms. Replace O-rings from Seal Kit Part No. 15431 contained in Seal Kit No. 15705.
- c) To reassemble, carefully guide the Coil (54) over the Valve Cartridge (55) and use the original External Brass Nut.
- d) Remove Relief Valve (40). Inspect Spring, Ball, Ball Seat (39) and O-Ring (38) for damage.
- e) Remove and clean the Filter Screen (27) using kerosene and blow out with air. Replace 1/4 I.D. O-rings (46) and 5/16 I.D. O-ring (47) from Seal Kit No. 15705.
- f) Remove Cap Plug (28) and lower adjustment screw (42). Inspect base for contamination or damage.

5. VALVE BLOCKS

- a) Remove items (83), (90) & (91). Clean "B" Solenoid (83) and inspect for damage. Disassemble Cartridge Valve (85) and replace O-rings from Seal Kit No. 15432 contained in Seal Kit No. 15705.
- b) Remove and clean "C" Solenoid (86) and inspect for damage. Disassemble Cartridge Valve (88) and replace O-rings and nylon back-up rings from Seal Kit No. 15433 contained in Seal Kit No. 15705. Be certain O-rings and spacers are oriented properly.
- c) Test both Coils (84 & 87) for electrical continuity. Nominal coil resistance is 3.7 ohms.
- d) Remove Plug (81) and Piston Assembly (80) and inspect the Piston for scratches. Replace O-ring (82) from Seal Kit No. 15705.
- e) Remove Pilot Check Valve Parts (76) and inspect all parts for damage.
- f) Remove all parts of Item (61) and inspect for damage. Replace O-rings from Seal Kit No. 15705. Set adjustable crossover to 3800 ± 400 P.S.I.
- g) With parts removed from Valve Block, clean and blow out with air to remove any foreign particles in Block.

6. UNIT REASSEMBLY

- a) Before reassembling, make certain all components and sub-assemblies are clean and free from all dirt and other foreign material.
- b) When replacing parts, install (77), (78) & (79) before installing Piston (80) and Plug (81).
- c) **USE NEW SEALS AND M-1 FLUID WHEN REASSEMBLING THE UNIT.**
- d) Proper fluid level is 1-1/2" below filler hole. It must be checked with Lift Ram fully retracted. **NOTE: Oil seepage, if any, at O-ring (74) is normal, DO NOT attempt to stop this seepage by further tightening of the Acorn Nut.**